

 **breviglieri**

# POWER HARROWS

ERPICI ROTANTI

HERSES ROTATIVES

KREISELEGGEN

GRADAS ROTATIVAS



 **breviglieri**

Uomini, idee, macchine.



# The range

Available for tractors from 30 up to 260 HP

- I Disponibili per trattori da 30 a 260 cv
- F Disponibles pour tracteurs de 30 à 260 cv
- D Verfügbar für Traktoren von 30 bis 260 PS
- E Disponibles para tractores de 30 a 260 cv

I La gamma F La gamme D Die Auswahl E La gama

## Mekfarmer 80



**30 - 80 HP**

cm. 110 - 130 - 150 - 170 - 190

## Mekfarmer 100



**60 - 100 HP**

cm. 200 - 230 - 250 - 300

## Mekfarmer 120



**90 - 120 HP**  
cm. 250 - 300 - 350

## Mekfarmer 150



**90 - 150 HP**  
cm. 250 - 300 - 350

## Mekfarmer 170



**100 - 170 HP**  
cm. 300 - 350 - 400

## Mekfarmer 220



**140 - 220 HP**  
cm. 300 - 350 - 400 - 450

## Mekfarmer K180



**100 - 180 HP**  
cm. 300 - 350 - 400

## Mekfarmer K230



**140 - 230 HP**  
cm. 300 - 350 - 400 - 450

## Mekfarmer K270



**150 - 270 HP**  
cm. 300 - 350 - 400 - 450



## BALL BEARINGS

- 1 Cuscinetti a sfera F Roulements à billes
- 2 Kugellager E Cojinetes a esferas

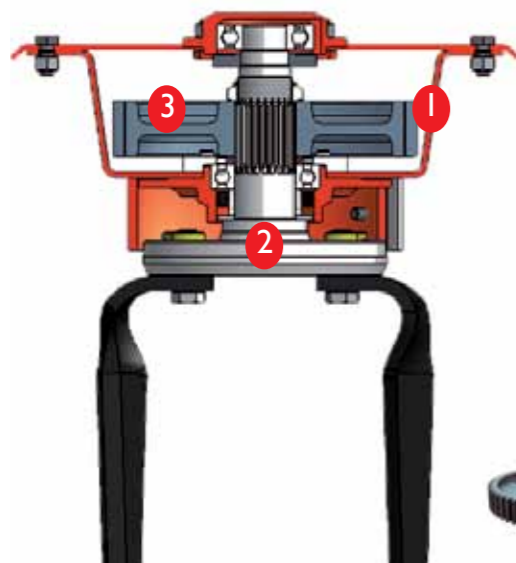

## TAPERED ROLLER BEARINGS

- 1 Cuscinetti conici F Roulements coniques
- 2 Konische Lagerungen E Cojinetes cónicos

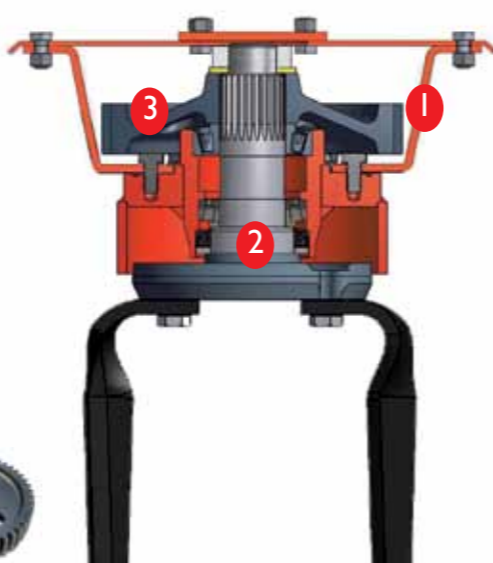

## SPECIAL MOUNTING OF BLADES

- 1 Fasatura coltelli F Décalage des couteaux D Zinken E Montaje special cuchillas

This system to assembly the blades allows:

- 1 Questo particolare sistema di montaggio dei coltelli consente:
- 2 Ce système spécial de montage des lames permet de:
- 3 Dieses spezielle Zinkenmontagesystem erlaubt:
- 4 Este sistema de montaje de las cuchillas permite de:

To reduce the absorption of power and a saving fuel consumption

- 1 Ridurre l'assorbimento di potenza e consumi di carburante
- 2 Réduire l'absorption de puissance et consommations de carburant
- 3 Die Absorption der Kraft und des Treibstoffverbrauchs zu verringern
- 4 Reducir la absorción de potencia y consumos de carburante

To eliminate the vibrations

- 1 Eliminare le vibrazioni
- 2 Éliminer les vibrations
- 3 Die Vibrationen zu entfernen
- 4 Eliminar las vibraciones

Fine clods for a perfect seeded

- 1 Zolle fini per una perfetta semina
- 2 Des mottes fines pour une parfaite semée
- 3 Dünne Scholle für eine perfekte Aussaat
- 4 Terrones finos para una perfecta siembra

## SIDE SHIELDS

- 1 Deflettori laterali F Déflécteurs latéraux D Seitenschilder E Deflectores laterales



| MOD.          | 1    | 2     | 3  | MOD.          | 1    | 2     | 3  | MOD.           | 1      | 2     | 3  |
|---------------|------|-------|----|---------------|------|-------|----|----------------|--------|-------|----|
| Mekfarmer 80  | mm 3 | mm 45 | 40 | Mekfarmer 150 | mm 5 | mm 50 | 48 | Mekfarmer K180 | mm 7+7 | mm 55 | 40 |
| Mekfarmer 100 | mm 5 | mm 45 | 40 | Mekfarmer 170 | mm 7 | mm 50 | 48 | Mekfarmer K230 | mm 7+7 | mm 55 | 40 |
| Mekfarmer 120 | mm 5 | mm 50 | 48 | Mekfarmer 220 | mm 7 | mm 50 | 48 | Mekfarmer K270 | mm 7+7 | mm 55 | 40 |

- 1 Flat-pan thickness steel
- 2 Spessore lamiera vasca
- 3 Epaisseur tôle
- 4 Dick des Bleches der Wanne
- 5 Espesor plancha
- 6 Side blade holder shaft diam.
- 7 Diametro albero portadente laterale
- 8 Diamètre arbre porte dent latéral
- 9 Seitliche Zinkenträger durchmesser
- 10 Diametro eje porta-diente central
- 11 Nr. tines gear transmission
- 12 N° denti ingranaggio di trasmissione
- 13 Nombre dents engrange
- 14 Nr. der Zahnen der Antriebszahnäder
- 15 Nr. dientes engranje de transmisión

## SUPERFAST

Without tools! Without effort!

- 1 Senza attrezzi! Senza fatica!
- 2 Sans outils! Sans fatigue!
- 3 Ohne Werkzeug! Ohne Mühe!
- 4 Sin las herramientas! Sin esfuerzo!

The BREVIGLIERI system in order to replace blades in a moment

- 1 Il sistema Breviglieri per sostituire gli utensili in un attimo
- 2 Le système BREVIGLIERI pour changer les outils dans un seul instant
- 3 Das BREVIGLIERI System für di Werkzeuge sofort zu ersetzen
- 4 El sistema BREVIGLIERI para substituir las cuchillas en un momento

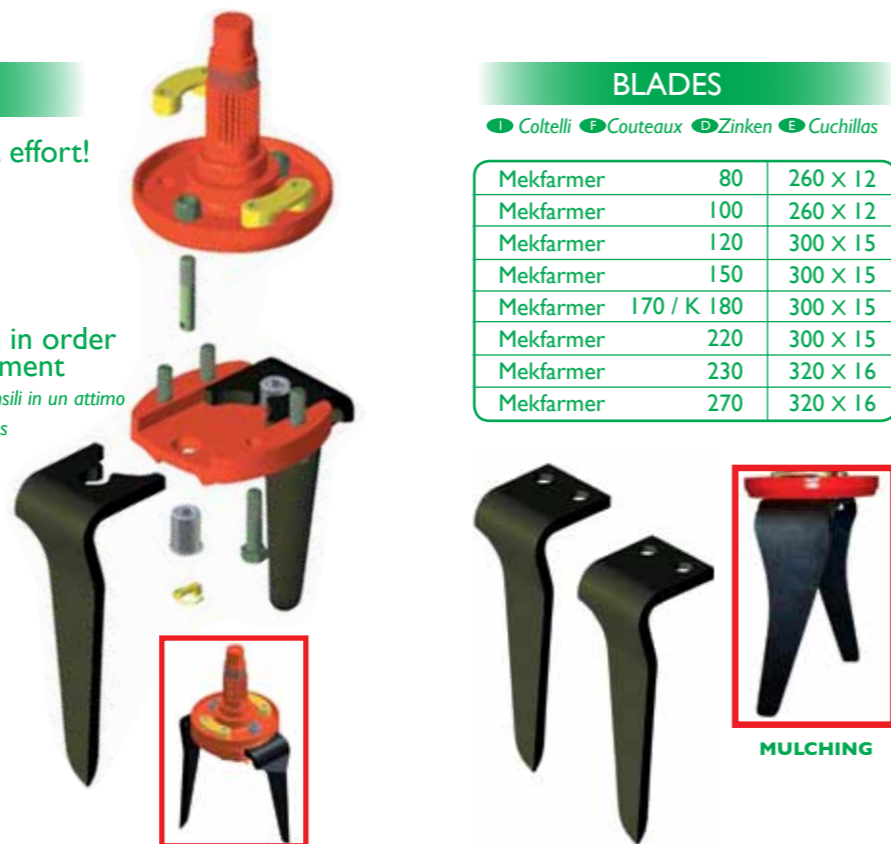

MULCHING

## AVAILABLE ON

- 1 Disponibile
  - 2 Disponible
  - 3 Verfügbar
  - 4 Disponible
- Mekfarmer 150 - 170 - 220 - K180 - K230 - K270



# TECHNICAL SECTION

## REAR ROLLERS

1 Rulli posteriori 2 Rouleaux arrière 3 Hintere Walzen 4 Rodillos posteriores



Spiked roller (Ø 477-525) (Ø 102-164)  
 1 Rullo dentato  
 2 Rouleau à dents  
 3 Zinkenwalze  
 4 Rodillo a dientes



Cage roller (Ø 370-405-450-500)  
 1 Rullo gabbia  
 2 Rouleau cage  
 3 Stabwalze  
 4 Rodillo jola



Packer roller (Ø 406-464-500-550)  
 1 Rullo packer  
 2 Rouleau packer  
 3 Zahnpackerwalze  
 4 Rodillo packer



Spiked roller maxi (Ø 525) (Ø 273)  
 1 Rullo dentato maxi  
 2 Rouleau à dents maxi  
 3 Zinkenwalze maxi  
 4 Rodillo dentado maxi



Crumbling roller (Ø 412-500)  
 1 Rullo sminuzzatore  
 2 Rouleau emoteur  
 3 Krumpenpackerwalze  
 4 Rodillo desmenuzador



Spiral roller (Ø 460)  
 1 Rullo spirale  
 2 Rouleau spire  
 3 Spiralwalze  
 4 Rodillo espiral

## ROLLERS ADJUSTEMENT

1 Regolazione rulli 2 Réglage rouleaux 3 Walzenverstellung 4 Ajuste rodillos



STANDARD  
 With pins  
 1 A perni  
 2 Par tourillons  
 3 Mit Spindel  
 4 A pernos



OPTION  
 Mechanical jacks (2)  
 1 Martinetti meccanici (2)  
 2 Vérins mécaniques (2)  
 3 Mit Bolzen (2)  
 4 Con tornillos (2)



OPTION  
 Hydraulic jacks (2)  
 1 Martinetti idraulico (2)  
 2 Vérins hydraulique (2)  
 3 Hydraulische Zylinder (2)  
 4 Cilindro hidráulico (2)

## PTO SHAFT

1 Cardano 2 Cardan 3 Gelenkwille 4 Cardan



With shear bolt  
 1 Con limitatore a bulloni  
 2 Avec limiteurs à boulons  
 3 Mit Scherstift  
 4 Con limitador a bulón

STANDARD  
 Mekfarmer 80-100



With slip clutch  
 1 Con frizione a dischi  
 2 Avec sécurité à disques  
 3 Rutschkupplung  
 4 Con embragues de discos

STANDARD  
 Mekfarmer 120-150-170-220  
 Mekfarmer K180-K230-K270

OPTION  
 Mekfarmer 80-100



With cam clutch  
 1 Con sicurezza automatica  
 2 Avec sécurité à came  
 3 Mit Nockenschaltkupplung  
 4 Con embrague de seguridad

OPTION  
 Mekfarmer 120-150-170-220  
 Mekfarmer K180-K230-K270

## HYDRAULIC SEEDER LINKAGE

1 Attacco idraulico seminatrici  
 2 Attelage hydraulique semair  
 3 Hydraulische Drillmaschinenanbauteile  
 4 Enganche hidráulico sembradora



MAX LOAD KG 2000

## BACK REFLEX PANELS



1 Pannelli retroriflettenti  
 2 Panneaux de signalisation  
 3 Erkennungstafel  
 4 Paneles retroreflejantes

OPTION  
 Mekfarmer 120-150  
 170-220  
 Mekfarmer K180  
 K230-K270

## STONE PROTECTION

1 Protezione sassi  
 2 Protéctions cailloux  
 3 Wickel Steinschutz  
 4 Protección piedras



STANDARD  
 Mekfarmer 150-170-220  
 Mekfarmer K180-K230-K270

OPTION  
 Mekfarmer 80-100-120

## REAR PTO

1 PDF Posteriore  
 2 PDF arrière  
 3 Hinter Durchtrieb  
 4 Toma de fuerza posterior



STANDARD  
 Mekfarmer 150-170-220  
 Mekfarmer K180-K230-K270

OPTION  
 Mekfarmer 100-120

## RIGID TRACK ERADICATOR

Ancora rompitraccia  
 1 Effaceur de trace  
 2 Spurlockerer  
 3 Eliminador de rostro



OPTION  
 Mekfarmer 80-100-120-150-170-220  
 Mekfarmer K180-K230-K270

## REAR LEVELLING BAR

1 Barra livellatrice posteriore  
 2 Barre niveleuse arrière  
 3 Hintere Planierschiene  
 4 Barra niveladora trasera











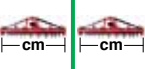

STANDARD  
 Mekfarmer 100-120-150-170-220  
 Mekfarmer K180-K230-K270

OPTION  
 Mekfarmer 80

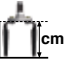
|                       |    |     |     | 540 RPM | 1000 RPM | Cod.    |          |
|-----------------------|----|-----|-----|---------|----------|---------|----------|
| Mekfarmer 80          | -  | -   | 324 | -       | -        | 8201423 | standard |
|                       | 19 | 21  | 293 | -       | -        | 8201423 | option   |
|                       | 21 | 19  | 358 | -       | -        | 8201427 |          |
|                       | 18 | 22  | 265 | -       | -        | 8201427 |          |
| Mekfarmer 100 - 120   | 22 | 18  | 396 | -       | -        | -       | standard |
|                       | 17 | 16  | 311 | -       | -        | 8201424 |          |
|                       | 16 | 17  | 275 | -       | -        | 8201428 |          |
|                       | 18 | 15  | 351 | -       | -        | 8201428 |          |
|                       | 15 | 18  | 244 | -       | -        | 8201429 |          |
| Mekfarmer 150         | 12 | 21  | -   | 309     | -        | 8201430 | option   |
|                       | 13 | 20  | -   | 352     | -        | 8201430 |          |
|                       | 32 | 24  | 348 | -       | -        | 8066254 |          |
|                       | 24 | 32  | -   | 362     | -        | 8066256 |          |
|                       | 30 | 26  | 301 | -       | -        | 8066257 |          |
|                       | 33 | 23  | 374 | -       | -        | 8066258 |          |
| Mekfarmer 170 / K 180 | 25 | 31  | -   | 389     | -        | 8066258 | option   |
|                       | 22 | 34  | -   | 312     | -        | 8066259 |          |
|                       | 26 | 35  | -   | 359     | -        | 8066239 |          |
|                       | 35 | 26  | 350 | -       | -        | 8066232 |          |
|                       | 21 | 40  | -   | 253     | -        | 8066233 |          |
|                       | 23 | 38  | -   | 292     | -        | 8066233 |          |
|                       | 38 | 23  | 430 | -       | -        | 8066234 |          |
|                       | 24 | 37  | -   | 313     | -        | 8066234 |          |
|                       | 37 | 24  | 402 | -       | -        | 8066235 |          |
|                       | 25 | 36  | -   | 335     | -        | 8066235 |          |
|                       | 36 | 25  | 375 | -       | -        | 8066236 |          |
|                       | 27 | 34  | 207 | 383     | -        | 8066236 |          |
| 34                    | 27 | 328 | -   | -       | 8066237  |         |          |
| 28                    | 33 | 221 | 410 | -       | 8066237  |         |          |
| 33                    | 28 | 307 | -   | -       | 8066238  |         |          |
| 29                    | 32 | 236 | 438 | -       | 8066238  |         |          |
| 32                    | 29 | 288 | -   | -       | -        |         |          |
| Mekfarmer 220 / K 230 | 18 | 19  | -   | 332     | -        | 8201426 | standard |
|                       | 19 | 18  | -   | 371     | -        | 8201433 |          |
|                       | 16 | 21  | -   | 267     | -        | 8201433 |          |
|                       | 21 | 16  | -   | 461     | -        | 8201434 |          |
|                       | 17 | 20  | -   | 298     | -        | 8201434 |          |
| Mekfarmer K 270       | 20 | 17  | -   | 413     | -        | -       | option   |
|                       | 30 | 39  | -   | 365     | -        | 8066462 |          |
|                       | 23 | 46  | -   | 238     | -        | 8066460 |          |
|                       | 27 | 43  | -   | 298     | -        | 8066461 |          |
| 33                    | 36 | -   | 435 | -       | 8066463  |         |          |

# Technical data

DATI TECNICI / DONNÉES TECHNIQUES / TECHNISCHE DATEN / DATOS TECNICOS

|  |  |  |  |     |  |  |  |            |            |  |       |       |  |       |       |  |       |       |  |       |  |
|--|---|---|---|-----|---|---|---|------------|------------|--|-------|-------|---|-------|-------|---|-------|-------|---|-------|--|
|  |   |   | KG  | KG  |   |   | KG  | KG         | KG         | KG   | KG    | KG    | KG  | KG    | KG    | KG  | KG    | KG    |   |       |  |
| Mod. MekFarmer   | HP  | rpm   | cm  | cm  | n.  | cm  | Ø 477<br>1  | Ø 525<br>2 | Ø 525<br>3 | Ø 405<br>x MekFarmer 80<br>Ø 370   | Ø 450 | Ø 500 | Ø 460   | Ø 412 | Ø 500 | Ø 406   | Ø 464 | Ø 500 | Ø 550   |       |  |
| <b>80-110</b>  | 30-44   | 540   |   | 110 | 113   | 10  | 8-27  | 340        |            |  | 308   |       |   |       |       |   |       |       | 342   |       |  |
| <b>80-130</b>  | 40-50   | 540   |   | 130 | 133   | 12  | 8-27  | 375        |            |  | 338   |       |   |       |       |   |       |       | 396   |       |  |
| <b>80-150</b>  | 50-60   | 540   |   | 150 | 153   | 14  | 8-27  | 410        |            |  | 368   |       |   |       |       |   |       |       | 450   |       |  |
| <b>80-170</b>  | 60-80   | 540   |   | 170 | 173   | 16  | 8-27  | 445        |            |  | 398   |       |   |       |       |   |       |       | 504   |       |  |
| <b>80-190</b>  | 70-80   | 540   |   | 190 | 193   | 18  | 8-27  | 480        |            |  | 428   |       |   |       |       |   |       |       | 558   |       |  |
| <b>100-200</b>   | 60-70   | 540   | 1000  | 200 | 205   | 20  | 8-27  | 680        |            |  | 670   | 700   |   | 690   | 680   |   | 780   | 810   |   |       |  |
| <b>100-230</b>   | 65-80   | 540   | 1000  | 230 | 235   | 22  | 8-27  | 730        |            |  | 700   | 730   |   | 720   | 710   |   | 830   | 860   |   |       |  |
| <b>100-250</b>   | 70-90   | 540   | 1000  | 250 | 255   | 24  | 8-27  | 780        |            |  | 750   | 780   |   | 770   | 760   |   | 880   | 910   |   |       |  |
| <b>100-300</b>   | 80-100  | 540   | 1000  | 295 | 300   | 28  | 8-27  | 880        |            |  | 850   | 880   |   | 870   | 860   |   | 980   | 1010  |   |       |  |
| <b>120-250</b>   | 90-110  | 540   | 1000  | 250 | 255   | 20  | 10-30   |            | 935        | 980  |       | 910   |   | 910   | 880   | 950   |       | 1110  | 1180  | 1250  |  |
| <b>120-300</b>   | 100-120   | 540   | 1000  | 295 | 300   | 24  | 10-30   |            | 1092       | 1137   |       | 1100  | 1200  | 1100  | 1070  | 1140  |       | 1195  | 1265  | 1335  |  |
| <b>120-350</b>   | 100-120   | 540   | 1000  | 345 | 350   | 28  | 10-30   |            | 1192       | 1237   |       | 1200  | 1300  | 1200  | 1170  | 1240  |       | 1295  | 1365  | 1435  |  |
| <b>150-250</b>   | 90-120  | 540   | 1000  | 243 | 252   | 20  | 10-30   |            | 1092       | 1138   |       | 1102  |   | 1102  | 1072  | 1142  |       | 1242  | 1312  | 1382  |  |
| <b>150-300</b>   | 110-140   | 540   | 1000  | 288 | 300   | 24  | 10-30   |            | 1212       | 1258   |       | 1223  | 1323  | 1220  | 1183  | 1253  |       | 1362  | 1432  | 1502  |  |
| <b>150-350</b>   | 120-150   | 540   | 1000  | 345 | 350   | 28  | 10-30   |            | 1282       | 1328   |       | 1293  | 1393  | 1290  | 1253  | 1323  |       | 1432  | 1502  | 1572  |  |
| <b>170 - 300 K180</b>  | 100-130   | 540   | 1000  | 295 | 300   | 24  | 10-30   |            | 1190       | 1236   |       | 1220  | 1320  | 1223  | 1180  | 1250  |       | 1420  | 1472  | 1552  |  |
| <b>170 - 350 K180</b>  | 110-150   | 540   | 1000  | 345 | 350   | 28  | 10-30   |            | 1330       | 1376   |       | 1360  | 1460  | 1360  | 1320  | 1390  |       | 1570  | 1640  |       |  |
| <b>170 - 400 K180</b>  | 120-170   | 540   | 1000  | 395 | 400   | 32  | 10-30   |            | 1470       | 1516   |       | 1500  | 1600  | 1500  | 1460  | 1530  |       | 1710  | 1780  |       |  |
| <b>220-300</b>   | 140-160   |   | 1000  | 295 | 300   | 24  | 10-30   |            | 1255       | 1301   |       | 1285  | 1385  | 1285  | 1245  | 1315  |       | 1450  | 1500  | 1570  |  |
| <b>220-350</b>   | 150-170   |   | 1000  | 345 | 350   | 28  | 10-30   |            | 1400       | 1446   |       | 1430  | 1530  | 1430  | 1390  | 1460  |       | 1640  | 1730  |       |  |
| <b>220-400</b>   | 170-200   |   | 1000  | 395 | 400   | 32  | 10-30   |            | 1550       | 1596   |       | 1580  | 1680  | 1580  | 1540  | 1610  |       | 1790  | 1860  |       |  |
| <b>220-450</b>   | 180-220   |   | 1000  | 445 | 450   | 36  | 10-30   |            | 1700       |  |       | 1730  | 1830  | 1730  | 1690  | 1760  |       | 1940  | 2010  |       |  |
| <b>K 230-300</b>   | 140-160   |   | 1000  | 295 | 300   | 24  | 10-32   |            | 1255       | 1301   |       | 1285  | 1385  | 1285  | 1245  | 1315  |       | 1450  | 1500  | 1570  |  |
| <b>K 230-350</b>   | 150-170   |   | 1000  | 345 | 350   | 28  | 10-32   |            | 1400       | 1446   |       | 1430  | 1530  | 1430  | 1390  | 1460  |       | 1640  | 1730  |       |  |
| <b>K 230-400</b>   | 170-200   |   | 1000  | 395 | 400   | 32  | 10-32   |            | 1550       | 1596   |       | 1580  | 1680  | 1580  | 1540  | 1610  |       | 1790  | 1860  |       |  |
| <b>K 230-450</b>   | 180-230   |   | 1000  | 445 | 450   | 36  | 10-32   |            | 1700       |  |       | 1730  | 1830  | 1730  | 1690  | 1760  |       | 1940  | 2010  |       |  |
| <b>K 270-300</b>   | 150-180   |   | 1000  | 295 | 300   | 24  | 10-32   |            | 1550       | 1595   |       | 1590  | 1690  | 1590  | 1550  | 1620  |       | 1730  | 1790  | 18060 |  |
| <b>K 270-350</b>   | 150-200   |   | 1000  | 345 | 350   | 28  | 10-32   |            | 1710       | 1750   |       | 1700  | 1760  | 1760  | 1720  | 1810  |       | 1900  | 2010  |       |  |
| <b>K 270-400</b>   | 160-230   |   | 1000  | 395 | 400   | 32  | 10-32   |            | 1935       | 1926   |       | 1900  | 2000  | 1900  | 1860  | 1930  |       | 2110  | 2180  |       |  |
| <b>K 270-450</b>   | 180-270   |   | 1000  | 445 | 450   | 36  | 10-32   |            |            |  |       | 2060  | 2160  | 2060  | 2020  | 2090  |       | 2270  | 2340  |       |  |

- 1** Tubo centrale Ø 102 (Ø 477)    **GB** Central tube Ø 102 (Ø 477)    **F** Tuyau centrale Ø 102 (Ø 477)    **D** Zentral Rohr Ø 102 (Ø 477)    **E** Tubo central Ø 102 (Ø 477)  
**2** Tubo centrale Ø 164 (Ø 525)    Central tube Ø 164 (Ø 525)    Tuyau centrale Ø 164 (Ø 525)    Zentral Rohr Ø 164 (Ø 525)    Tubo central Ø 164 (Ø 525)  
**3** Tubo centrale Ø 273 (Ø 525)    Central tube Ø 273 (Ø 525)    Tuyau centrale Ø 273 (Ø 525)    Zentral Rohr Ø 273 (Ø 525)    Tubo central Ø 273 (Ø 525)

